

AIRCRAFT PARKING/
DOCKING CHART (PDC)

RIO DE JANEIRO / Santa Cruz, MIL (SBSC)

RJ - BRASIL

AD ELEV: 10'

ARP S22 55 58 W043 43 10

PDC 2

ATIS NIL	CLRD 132.20 132.50 133.70	GNDC 121.80	TWR 118.80 122.90	APRON NIL
-------------	------------------------------	----------------	----------------------	--------------

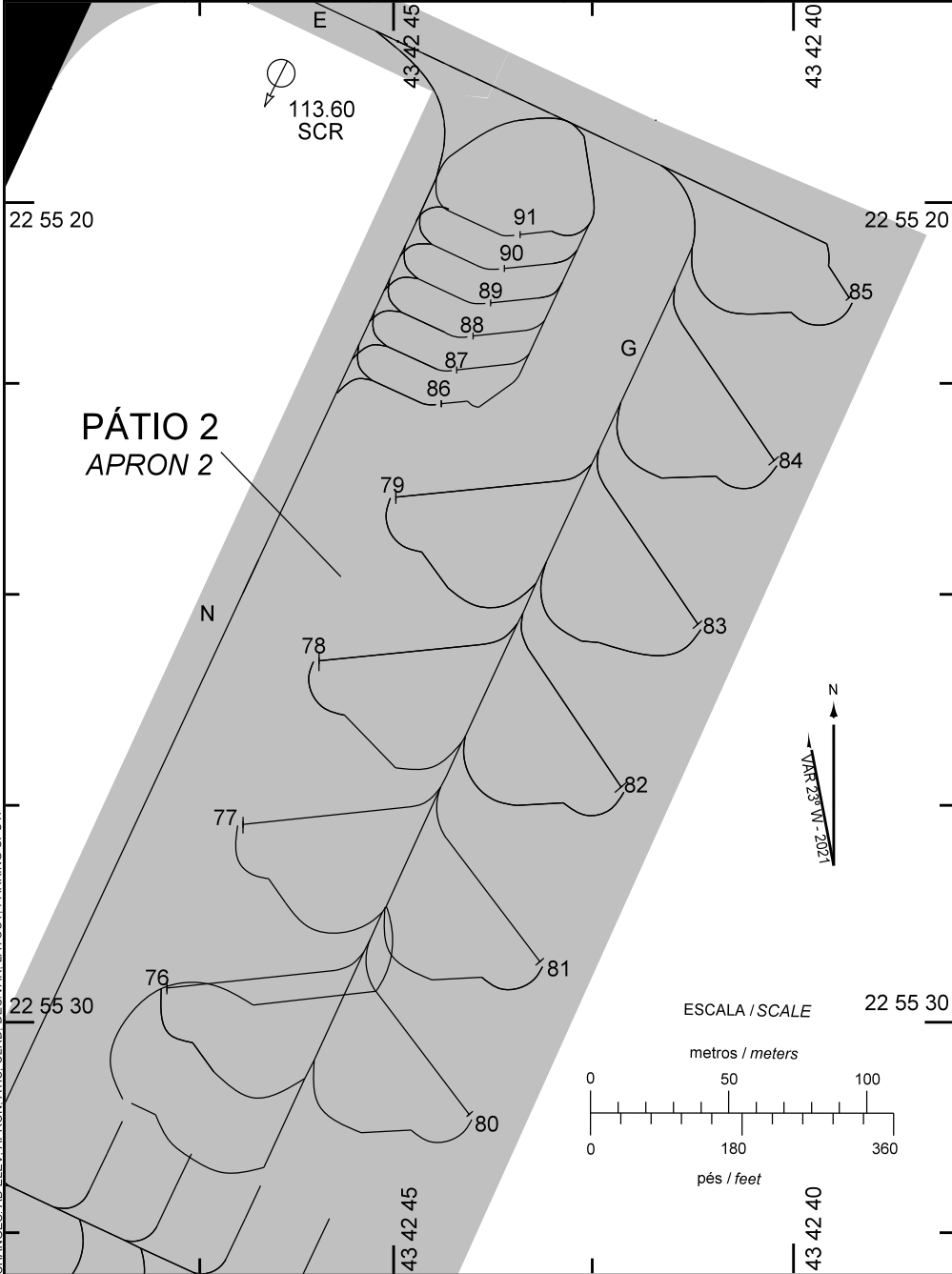

CHANGES: AD ELEV, APRON, ATIS, CLRD, DECAVAR, LAYOUT, PARKING SPOT.

PDC 2 - SBSC: INFORMAÇÕES COMPLEMENTARES/COMPLEMENTARY INFORMATION

**COORDENADAS DOS PONTOS DE ESTACIONAMENTO
PARKING SPOT COORDINATES**

PONTO SPOT	COORDENADAS COORDINATES	PONTO SPOT	COORDENADAS COORDINATES
PÁTIO 2 / APRON 2			
76	22 55 29.58 S 43 42 47.75 W		
77	22 55 27.64 S 43 42 46.82 W		
78	22 55 25.70 S 43 42 45.88 W		
79	22 55 23.76 S 43 42 44.93 W		
80	22 55 31.02 S 43 42 43.89 W		
81	22 55 29.21 S 43 42 43.02 W		
82	22 55 27.14 S 43 42 42.02 W		
83	22 55 25.21 S 43 42 41.07 W		
84	22 55 23.27 S 43 42 40.13 W		
85	22 55 21.34 S 43 42 39.21 W		
86	22 55 22.66 S 43 42 44.37 W		
87	22 55 22.26 S 43 42 44.18 W		
88	22 55 21.86 S 43 42 43.98 W		
89	22 55 21.46 S 43 42 43.76 W		
90	22 55 21.06 S 43 42 43.59 W		
91	22 55 20.65 S 43 42 43.40 W		

CHANGES: AD ELEV, APRON, ATIS, CLRD, DECIVAR, LAYOUT, PARKING, SPOT